

## STANDARD PROCEDURE - JACKING AND HOISTING

**WARNING:**

The hoisting and jack lifting points provided are for a complete vehicle. When the engine or rear suspension is removed from a vehicle, the center of gravity is altered making some hoisting conditions unstable. Properly support or secure vehicle to hoisting device when these conditions exist. Failure to follow these instructions may result in serious or fatal injury.

**CAUTION:**

Due to variations in hoist design it may be necessary to use the secondary lift points to avoid damage to the body or trim parts.

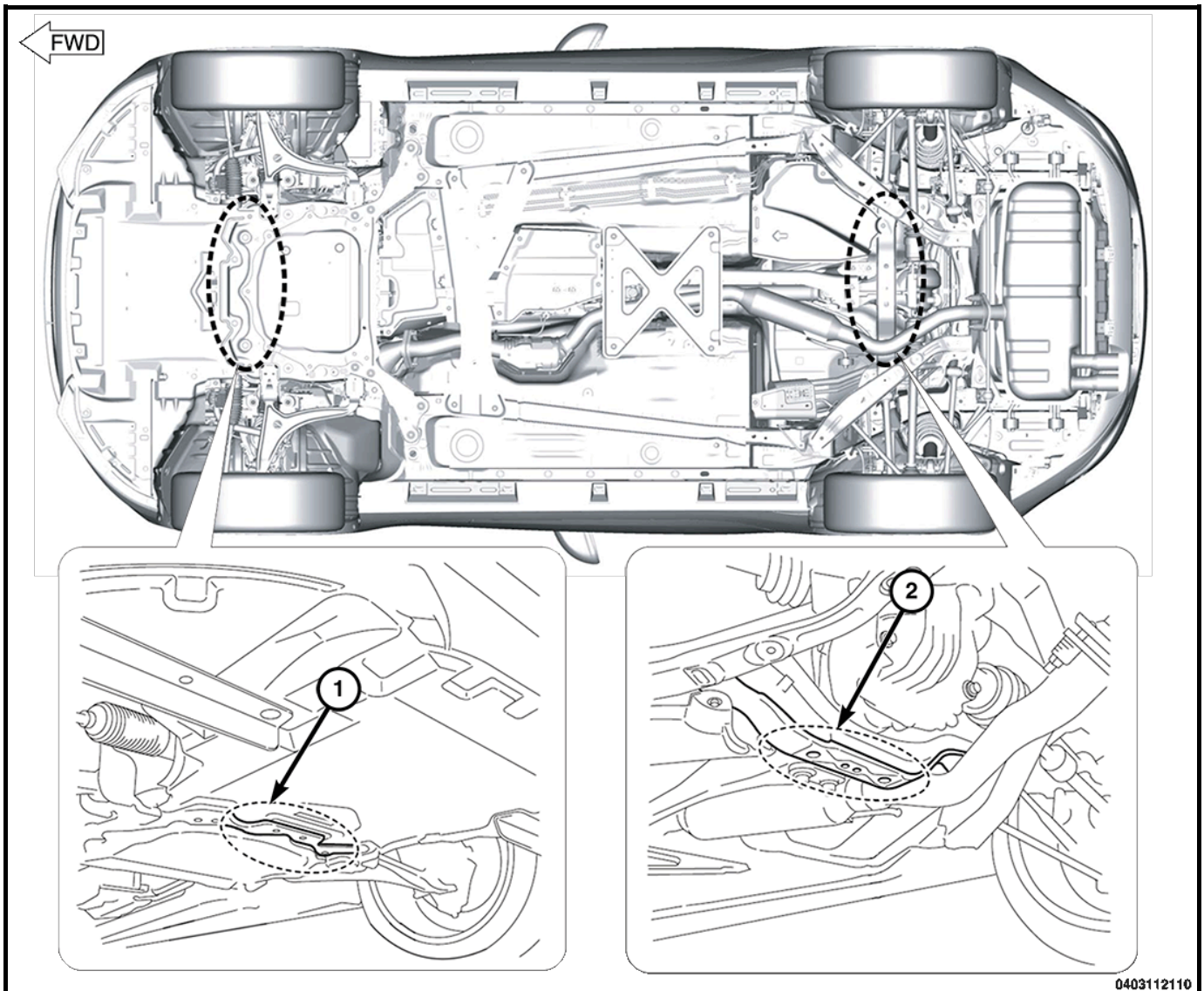

## JACKING LOCATIONS

1. Front Crossmember
2. Rear Undercover

### NOTE:

To prevent obstruction between the jack body and front bumper when the jack body is inserted, use a low floor type jack.

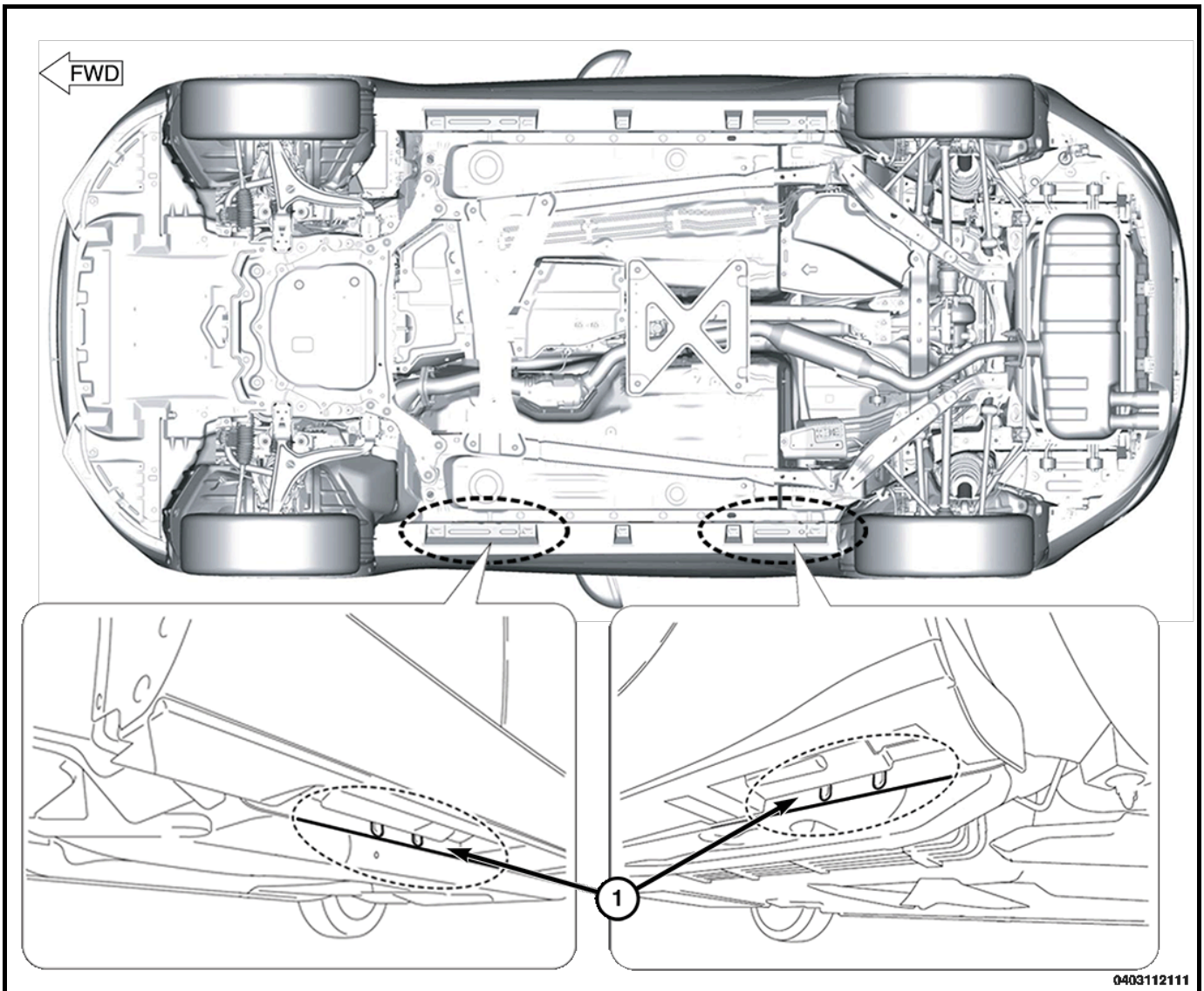

## HOISTING LOCATIONS

## Front And Rear

- Both sides of the vehicle, on side sills.

A hoist with asymmetrical hoist arms can not be adjusted to a position which will allow the hoist adapters to engage the service hoisting locations on the down standing weld flange (1) on the sill at both the rear and the front of the vehicle. Therefore, the secondary service hoisting location will need to be used at the front of the vehicle. The secondary front service hoisting location is the front torque box.

When properly positioned, a floor jack can be used to lift the vehicle and support the raised vehicle with jack stands.

A floor jack or any lifting device must never be used on any part of the underbody other than the described areas.